

ICW Series

v1.0 3_19_25



1025 Conroy Place Easton, PA 18040
888-TORCUP-1 | sales@torcup.com

OPERATION AND MAINTENANCE

MANUAL

ICW SERIES Industrial Clicker Torque Wrench

MODEL ICW 100, 250, 450, 750
& 1000

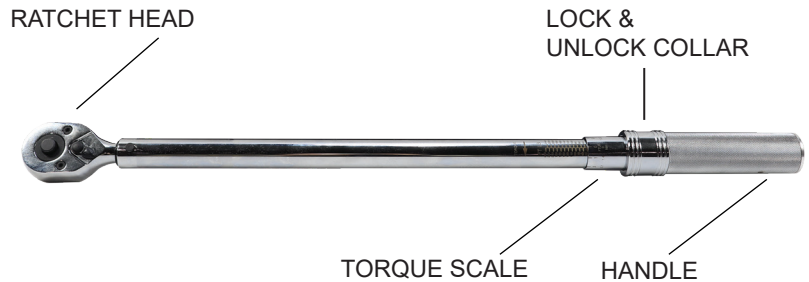

ABOUT

The ICW Series conforms to ISO 6789-1:2017 and 678-2:2017 standards. The calibration certificate provided is NIST traceable. To maintain the tool at such standards, testing must be done every 5,000 cycles or every six months.

CONVERT FROM	TO	MULTIPLY BY
ozf-in	lbf-in	0.0625
lbf-in	ozf-in	16
lbf-in	kgf-cm	1.1519
lbf-in	lbf-ft	0.083333
lbf-in	kgf-m	0.011519
lbf-in	N-m	0.1130
lbf-in	dN-m	1.130
lbf-ft	N-m	1.356
lbf-ft	kgf-m	0.1382
lbf-ft	lbf-in	12
N-m	dN-m	10
N-m	kgf-cm	10.20
N-m	kgf-m	0.10197
N-m	lbf-in	8.8507
N-m	lbf-ft	0.73756
dN-m	lbf-in	0.885
dN-m	N-m	0.100
kgf-cm	lbf-in	0.8681
kgf-cm	N-m	0.09807
kgf-m	lbf-ft	7.233
kgf-m	N-m	9.807

OPERATION

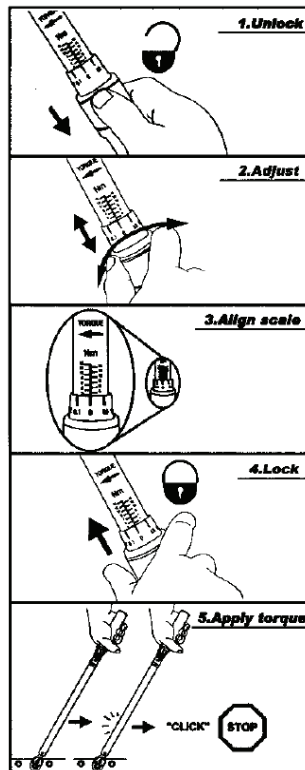

EXTENSION & ADAPTER

When using an extension or adapter (increasing the effective length of the torque wrench) the output torque value will change. To calculate the new torque output of the wrench use the following formula:

$$A = \frac{L + C}{L} \times B$$

A = Torque exerted @ end of adapter
L = Distance between square drive and hand position
B = Wrench scale reading
C = Length of adapter or extension

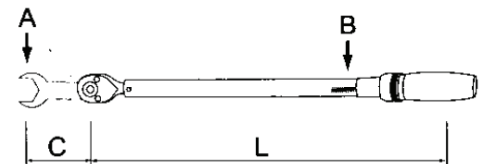

A number of variables including the length of the adapter or extension, length of the wrench and variations in hand position on the wrench will affect the accuracy of the above calculation.

WARNING: DO NOT PUT EXTENSION ON HANDLE

CARE & MAINTENANCE

1. The torque wrench is a precision instrument, and should be stored with care. Don't throw it around, use a hammer on it, or use it as lever bar.
2. The torque wrench is lubricated for life and should not be oiled. The only exception is the ratchet head which may be lubricated as needed for smooth operation.
3. Calibration must be done regularly (recommended every 6 months) to ensure accuracy.
4. Always store the torque wrench in the box after use to stay away from dirt and humidity.
5. Never disassemble the torque wrench by yourself. Seek assistance from a certified service station. Incorrect action can damage the tool.
6. Set torque value to lowest value after completed use.
7. Calibration may only be done by an authorized laboratory or workshop.

SAFETY

WARNING - RISK OF PROJECTILES - USE EYE PROTECTION

- Use only for controlled tightening of fasteners
- Do not use to break loose or loosen fasteners
- Use clockwise action only (according to the marking on the torque wrench)
- Do not use when damaged or with damaged items
- Do not use as a hammer
- Do not use as a lever bar
- If not calibrated may cause damage to parts or tool
- Do not over tighten
- Handle is not insulated, do not use on live or high voltage circuits